

8TH FLOOR PLAN  
SCALE:1:100

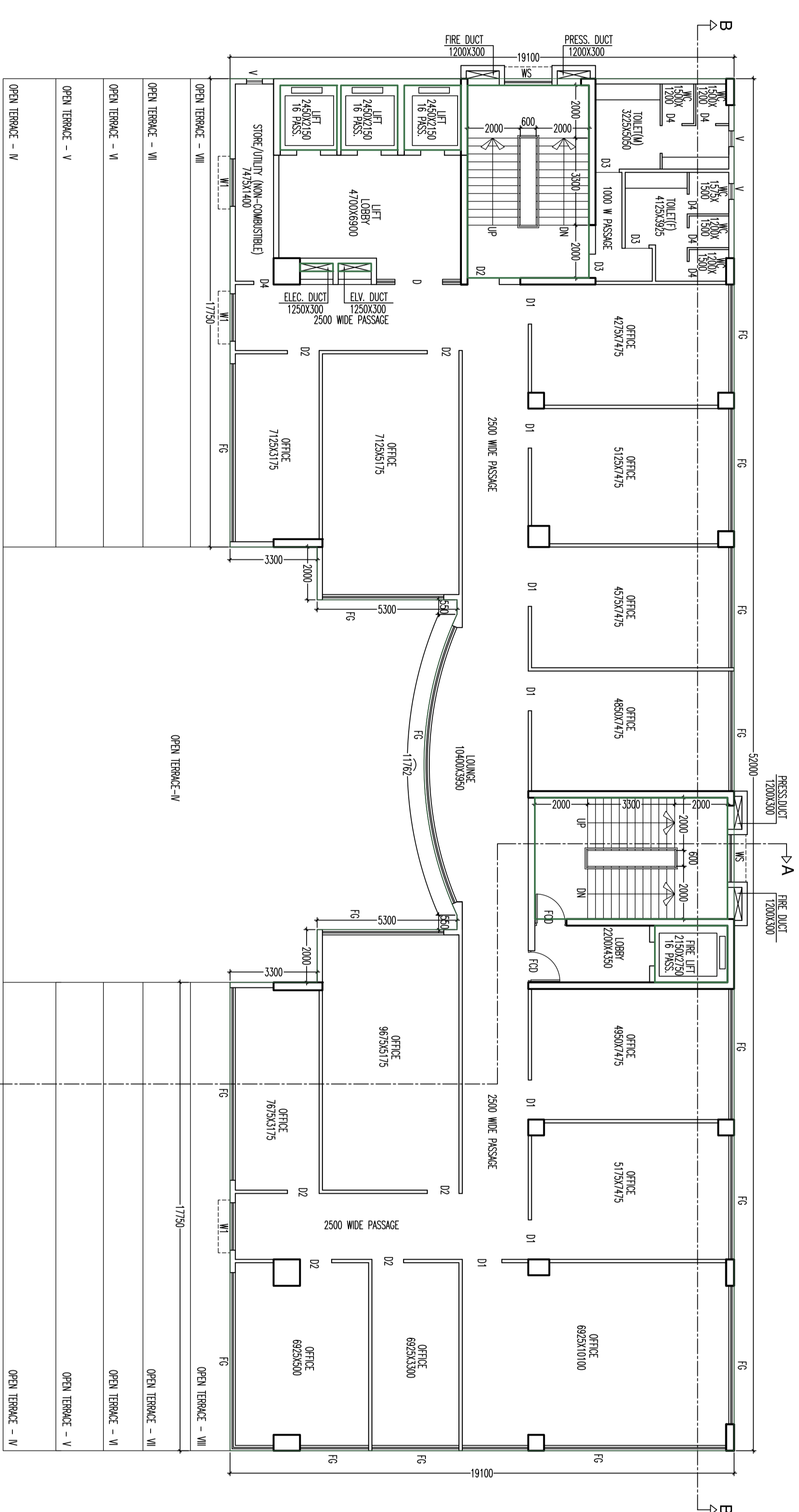

9TH FLOOR PLAN  
SCALE:1:100

SCHEDULE OF DOORS			
TYPE	SIL	UNITS	REMARKS
D1	-	2400	1800X2400
D2	-	2400	1200X2400
D3	-	2400	1000X2100
D4	-	2400	500X2400
D5	-	2100	700X2100
FCD1	-	2400	1800X2400
FCD2	-	2400	1200X2400
SCHEDULE OF WINDOWS			
TYPE	SIL	UNITS	REMARKS
W1	1050	2400	1000X1500
W4	900	2400	500X1500
V	1200	2100	500X900
W5	900	2400	500X1500
W6	1000	2400	500X1500
W7	1000	800	850X750

**SIGNATURE OF OWNER**  
MAHESH KUMAR AGARWAL  
SUNNYSIDE NEWZ AND ALLED SERVICES PVT LTD  
ADDRESS: 230A, A.C ROSE ROAD, CHITRAKOOT BUILDING, 7TH FLOOR,  
KOLKATA - 700020

**CERTIFICATE OF ARCHITECT**  
I CERTIFY THAT ALL THE ARCHITECTURAL DRAWINGS OF THE PROJECT AT REFERENCE NO. 800X900, DRAWINGS HAVE BEEN REVIEWED BY ME, CHARTERED ARCHITECT AND DRAWINGS PREPARED BY ME, COMPLY WITH ALL PROVISIONS OF THE ARCHITECTURAL ACT, 1930 AND THE ARCHITECTURAL REGULATIONS MADE UNDER THE ACT AND ALSO CONSIDERING ALL POSSIBLE STRUCTURAL AND MECHANICAL ASPECTS AND NATIONAL BUILDING REGULATIONS, I HAVE ISSUED THIS CERTIFICATE OF APPROVAL IN THE DEPTH THAT HAS BEEN PROVIDED IN THE GEO-TECHNICAL REPORT.

**SIGNATURE OF ARCHITECT**  
PAULANBAR AGARWAL  
ACHARNKAVI/0001006.

**CERTIFICATE OF STRUCTURAL ENGINEER**  
I CERTIFY THAT THE STRUCTURAL DRAWING AND DESIGN OF BOTH THE FOUNDATION AND SUPERSTRUCTURE OF THE BUILDING UNDER REFERENCE NO. 800X900, DRAWINGS HAVE BEEN REVIEWED BY ME, CHARTERED STRUCTURAL ENGINEER AND DRAWINGS PREPARED BY ME, COMPLY WITH ALL PROVISIONS OF THE ARCHITECTURAL ACT, 1930 AND THE ARCHITECTURAL REGULATIONS MADE UNDER THE ACT AND ALSO CONSIDERING ALL POSSIBLE STRUCTURAL AND MECHANICAL ASPECTS AND NATIONAL BUILDING REGULATIONS, I HAVE ISSUED THIS CERTIFICATE OF APPROVAL IN THE DEPTH THAT HAS BEEN PROVIDED IN THE GEO-TECHNICAL REPORT.

**SIGNATURE OF STRUCTURAL ENGINEER**  
ANANT AGARWAL  
S/TECHNICAL/DRAWING  
I CERTIFY THAT THE STRUCTURAL DRAWING AND DESIGN OF BOTH THE FOUNDATION AND SUPERSTRUCTURE OF THE BUILDING UNDER REFERENCE NO. 800X900, DRAWINGS HAVE BEEN REVIEWED BY ME, CHARTERED STRUCTURAL ENGINEER AND DRAWINGS PREPARED BY ME, COMPLY WITH ALL PROVISIONS OF THE ARCHITECTURAL ACT, 1930 AND THE ARCHITECTURAL REGULATIONS MADE UNDER THE ACT AND ALSO CONSIDERING ALL POSSIBLE STRUCTURAL AND MECHANICAL ASPECTS AND NATIONAL BUILDING REGULATIONS, I HAVE ISSUED THIS CERTIFICATE OF APPROVAL IN THE DEPTH THAT HAS BEEN PROVIDED IN THE GEO-TECHNICAL REPORT.

**SIGNATURE OF GEOTECHNICAL ENGINEER**  
G/TECHNICAL/DRAWING

**TITLE**  
EIGHTH & NINTH FLOOR PLAN

**PROJECT**  
PROPOSED PLAN OF B+G+X STORED  
BUSINESS BUILDING AT PREMISES NO:  
09-0776, PLOT NO-11D/24, ACTION  
AREA-11D, NEWTOWN,  
KOLKATA-700161, UNDER NEWTOWN P.S.  
KOLKATA.

DATE	JOB NO.	DEALT	SCALE	SHEET NO.
27.03.23	ARCH/2023/788	POULAMI	1:100	5/8

**RAJ AGARWAL & ASSOCIATES**  
8B, ROYD STREET, KOLKATA - 16